

CAESAR 12 STANDARD RETAINING WALL SYSTEM

ST. LOUIS COUNTY MASTERPLAN

INDEX OF DRAWNGS:

SHEET 1	COVER SHEET
SHEET 2	APPLICATIONS AND DESIGN INFORMATION
SHEET 3	SPECIFICATIONS
SHEET 4,5,6,7	DETAILS
SHEET 8	STANDARD DESIGN - FLAT BACKFILL
SHEET 9	STANDARD DESIGN - SLOPING BACKFILL
SHEET 10	STANDARD DESIGN - TIERED WALLS

MIDCOAST & ASSOCIATES, LLC
636-978-7770
O'FALLON, MO
MO COA #E-2013015539

CAESAR 12 STANDARD
RETAINING WALL SYSTEM

MIDWEST BLOCK & BRICK
12901 ST. CHARLES ROCK RD
BRIDGETON, MO 63044
314-291-3200
314-291-0265 FAX

COVER SHEET

SHEET 1 OF 10

DATE: APRIL 2014

APPLICATION:

THE CAESAR 12 STANDARD RETAINING WALL SYSTEM IS A REINFORCED SOIL STRUCTURE COMBINING AN ARCHITECTURALLY ATTRACTIVE CONCRETE FACING BLOCK WITH GEOGRID REINFORCEMENT. THE GEOGRID REINFORCEMENT INTERLOCKS WITH THE CAESAR BLOCK UNITS AND FILL SOIL TO CREATE A STABLE GRAVITY RETAINING WALL. DESIGN OF THESE REINFORCED SOIL STRUCTURES USES WELL ESTABLISHED GUIDELINES THAT ARE READILY AVAILABLE. THE FOLLOWING SPECIFICATIONS AND DETAILS PROVIDE A DESIGN TO INCORPORATE GEOGRID REINFORCEMENT INTO THE SOIL FOR THE PURPOSES OF CONSTRUCTING RETAINING WALLS. CONSULT MIDWEST BLOCK AND BRICK FOR ADDITIONAL DETAILS REGARDING DESIGN, APPEARANCE AND AESTHETIC CONSIDERATIONS.

STANDARD DESIGN PROCEDURE:

THE FOLLOWING DESIGN TABLES ESTABLISHED FOR THE CONSTRUCTION OF SOIL REINFORCED WALLS ARE BASED UPON GENERALLY ACCEPTED SOIL PARAMETERS IN THE ST LOUIS COUNTY, MISSOURI AREA. ALL SOIL PARAMETERS ASSUMED IN THE DESIGN ARE WELL DRAINED, LONG TERM STRENGTH CONDITIONS. HIGH PLASTIC SILTS AND CLAYS SHOULD BE AVOIDED WITHOUT SPECIFIC DESIGN RECOMMENDATIONS FROM LOCAL GEOTECHNICAL ENGINEERS. FROST HEAVE AND SETTLEMENT NEED TO BE ADDRESSED IF WARRANTED BY CONDITIONS. ALSO, SPECIFIC PRECAUTIONS ARE NECESSARY FOR WALLS CONSTANTLY IN CONTACT WITH WATER, I.E. NEAR OR AT RIVERS, LAKES AND PONDS.

THREE TYPICAL GEOMETRIC CASES WERE SELECTED FOR THESE TABLES. THE FIRST CASE IS A TYPICAL RETAINING WALL WITH HORIZONTAL BACKFILL AND 100 PSF SURCHARGE, THE SECOND CASE IS A 3:1 SLOPING BACKFILL AND THE THIRD CASE IS A TIERED WALL. THE FOLLOWING IS A SUMMARY OF THE DESIGN PARAMETERS USED AND THE MINIMUM FACTORS OF SAFETY WHICH THE TABLES ARE BASED ON.

SOIL PROPERTIES:

	FRICTION ANGLE (DEGREES)	UNIT WEIGHT (LBS/CF)	COHESION (LBS/SF)
WALL FILL	28	120	0
RETAINED BACKFILL	28	120	0
FOUNDATION SOIL	28	120	0

FRICTION ANGLE - DEGREES
UNIT WEIGHT - LBS PER CUBIC FOOT
COHESION - LBS PER SQUARE FOOT

MINIMUM FACTORS OF SAFETY CALCULATED:

REINFORCEMENT PULLOUT = 1.5
REINFORCEMENT RUPTURE = 1.5
EXTERNAL SLIDING = 1.5
INTERNAL SLIDING = 1.5
OVERTURNING = 2.0
BEARING CAPACITY = 1,500 PSF



MIDCOAST & ASSOCIATES, LLC
636-978-7770
O'FALLON, MO
MO COA #E-2013015539

CAESAR 12 STANDARD
RETAINING WALL SYSTEM

MIDWEST BLOCK & BRICK
12901 ST. CHARLES ROCK RD
BRIDGETON, MO 63044
314-291-3200
314-291-0265 FAX

APPLICATIONS

SHEET 2 OF 10

DATE: APRIL 2014

SPECIFICATIONS - ST LOUIS COUNTY MASTERPLAN:

MATERIALS:

RETAINING WALL UNITS SHALL BE CAESAR 12 STANDARD UNITS AS MANUFACTURED BY MIDWEST BLOCK AND BRICK. THE UNITS ARE 6" TALL x 18" WIDE x 12" DEEP. CONCRETE WALL UNITS SHALL MEET THE REQUIREMENTS OF ASTM C1372-01 WITH THE MAXIMUM WATER ABSORPTION LIMITED TO 8.0 PERCENT. THE CONCRETE SHALL HAVE ADEQUATE FREEZE THAW RESISTANCE IN ACCORDANCE WITH ASTM C1372-11.

REINFORCED WALL BACKFILL MATERIAL SHALL BE COMPACTED SOIL FROM ON-SITE. THE SOIL SHALL BE FREE OF CLUMPS, FREE OF ROCKS LARGER THAN 4" AND FREE OF ORGANIC MATERIALS. DO NOT USE HIGH PLASTIC SOILS THAT HAVE PI>20 OR LL>40.

GEOGRIDS SHALL BE STRATA SG150 OR SG200 AS MANUFACTURED BY STRATA SYSTEMS, INC. BOTH OF THESE GEOGRIDS MEET THE STRENGTH REQUIREMENTS OF THE DESIGN CALCULATIONS.

GEOTEXTILE FILTER FABRIC SHALL BE A NONWOVEN FABRIC WITH A MINIMUM WEIGHT OF 3.5 OZ/SY.

LEVELING PAD SHALL BE CONSTRUCTED OF WELL GRADED CRUSHED LIMESTONE SIMILAR TO 1" MINUS.

DRAINAGE ROCK SHALL BE FREE DRAINING ROCK SUCH AS 3/4" CLEAN CRUSHED LIMESTONE.

PERFORATED PIPE SHALL BE HDPE COIL PIPE.

WALL FOUNDATION:

FOUNDATION SOIL SHALL BE EXCAVATED AS REQUIRED FOR THE LEVELING PAD AND THE REINFORCED FILL ZONE TO THE DEPTHS AND LOCATIONS SHOWN ON THE PLAN SHEET. THE EXPOSED FOUNDATION SOIL SHALL BE OBSERVED PRIOR TO CONSTRUCTION TO VERIFY THAT THE EXPOSED MATERIAL IS SUITABLE FOR A NET DESIGN BEARING PRESSURE OF 1,500 PSF AND THAT THE BASE OF THE EXCAVATION IS FREE OF LOOSE SOIL, UNCOMPACTED FILL, WATER OR FROZEN MATERIAL. UNDERCUT ANY UNSUITABLE SOIL. UNDERCUT AREAS SHALL BE FILLED WITH CRUSHED LIMESTONE AND COMPACTED TO AT LEAST 95% OF THE MATERIAL'S STANDARD PROCTOR MAXIMUM DRY DENSITY.

CONSTRUCT THE CRUSHED ROCK LEVELING PAD TO LINES AND GRADE SHOWN ON THE PLANS.

CONSTRUCT THE HORIZONTAL DRAINAGE LAYER AT THE LINES AND GRADES SHOWN ON THE PLANS. THE 12" OF DRAINAGE ROCK SHALL BE SEPARATED FROM THE REINFORCED WALL BACKFILL WITH A FILTER FABRIC. PLACE THE PERFORATED PIPE BEHIND THE BASE UNIT AND IN THE DRAINAGE LAYER. SLOPE THE PIPE TO THE LOW POINT IN THE WALL AND DAYLIGHT THE PIPE THROUGH THE WALL FACE.

WALL CONSTRUCTION:

INSTALL THE FIRST COURSE OF UNITS ON THE LEVELING PAD. INSTALL THE NEXT COURSE IN A RUNNING BOND CONFIGURATION. PULL UNIT FORWARD. UNITS MAY NEED TO BE CUT TO MAINTAIN THE RUNNING BOND AROUND CURVED SECTIONS. A MINIMUM OF 4" OF THE UNIT SHALL OVERLAP THE UNIT BELOW IT. BACKFILL UNITS AND CONTINUE CONSTRUCTION. CAP UNITS SHALL BE GLUED IN PLACE AT THE TOP OF THE WALL.

DRAINAGE ROCK SHALL BE DIRECTLY BEHIND THE WALL UNITS A MINIMUM OF 12" THICK.

GEOGRID REINFORCING:

THE GEOGRID SHALL BE CUT TO DESIGN LENGTHS AND PLACED BETWEEN THE BLOCKS AT THE ELEVATIONS SHOWN ON THE PLANS. THE GEOGRID'S PRIMARY STRENGTH DIRECTION WILL BE DIRECTED PERPENDICULAR TO THE WALL FACE (INTO THE FILL). THE GEOGRIDS PLACED OUTSIDE A PLUS OR MINUS 4" ZONE OF THE GEOGRID DESIGN ELEVATION WILL NOT BE ACCEPTED. THE GEOGRID SHALL BE PLACED HORIZONTALLY AND LAY FLAT ON THE REINFORCED FILL SOIL. THE GEOGRID SHALL BE PLACED SO A MINIMUM OF 8" OF GRID IS BETWEEN BLOCK LAYERS. SLACK IN THE GEOGRID SHALL BE REMOVED PRIOR TO PLACING ADDITIONAL BACKFILL.

THE UPPER BLOCK AT ALL GEOGRID LOCATIONS SHALL HAVE THE REAR LIP REMOVED.

WALL BACKFILL:

WALL BACKFILL MATERIAL SHALL BE PLACED IN 8" MAXIMUM LOOSE LIFTS AND COMPACTED TO AT LEAST 95% OF THE MATERIAL'S MAXIMUM DRY DENSITY AS DETERMINED BY THE STANDARD PROCTOR METHOD. BACKFILL SHALL BE PLACED, SPREAD AND COMPACTED IN SUCH A MANNER THAT MINIMIZES WRINKLES AND MOVEMENT OF THE GEOGRID.

PLACE 12" OF DRAINAGE ROCK BEHIND UNITS. SEPARATE DRAINAGE ROCK AND SOIL WITH THE FILTER FABRIC.

DURING BACKFILL PLACEMENT THE 3 FOOT ZONE DIRECTLY BEHIND THE WALL SHALL BE LIMITED TO THE USE OF HAND OPERATED COMPACTION EQUIPMENT ONLY.

CONSTRUCTION EQUIPMENT SHALL NOT BE OPERATED DIRECTLY ON THE GEOGRID.

PROTECTION OF WORK:

THE SURFACE OF THE WALL BACKFILL SHALL BE GRADED AT THE END OF EACH DAY OF WORK TO PROVIDE POSITIVE SURFACE DRAINAGE AWAY FROM THE WALL. GRADING SHALL INCLUDE PROPER COUNTOURING OF FILLS IN ADJACENT AREAS TO PREVENT THE FLOW OF SURFACE WATER INTO THE REINFORCED EARTH ZONE.

THE DESIGN OF THE WALL IS BASED ON CONDITIONS AND LOADS IMPOSED ON THE WALL AT COMPLETION OF THE PROJECT. PRIOR TO PROJECT COMPLETION, THE WALL IS VULNERABLE TO DAMAGES CAUSED BY CONSTRUCTION ACTIVITY ADJACENT TO THE WALL. OF PARTICULAR CONCERN IS GRADING AND PAVEMENT CONSTRUCTION EQUIPMENT ON THE RETAINED BACKFILL AT THE TOP OF THE WALL. ONLY EQUIPMENT WITH A WEIGHT NOT EXCEEDING ONE TON CAN BE USED IN THE 3 FOOT ZONE DIRECTLY BEHIND THE BACK OF THE WALL FACE.

THE SOIL IN FRONT OF THE WALL SHALL BE PROTECTED FROM FUTURE EROSION.

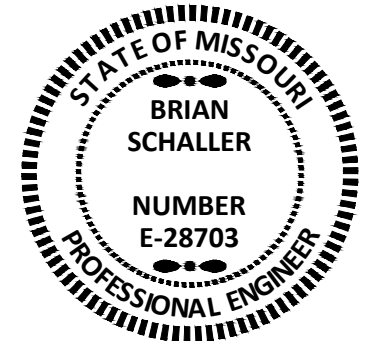

MIDCOAST & ASSOCIATES, LLC
636-978-7770
O'FALLON, MO
MO COA #E-2013015539

CAESAR 12 STANDARD
RETAINING WALL SYSTEM

MIDWEST BLOCK & BRICK
12901 ST. CHARLES ROCK RD
BRIDGETON, MO 63044
314-291-3200
314-291-0265 FAX

SPECIFICATIONS

SHEET 3 OF 10

DATE: APRIL 2014

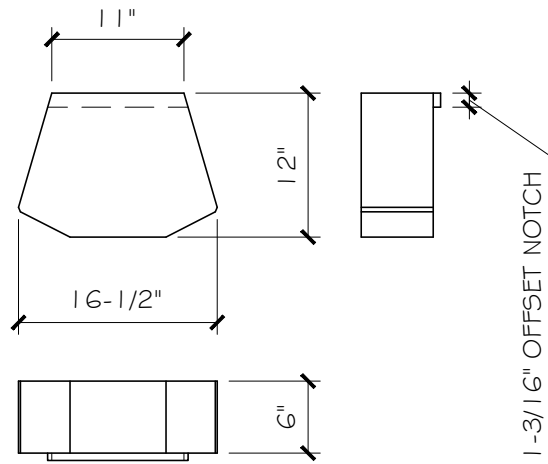

BEVELED FACE BLOCK DETAIL

NOT TO SCALE

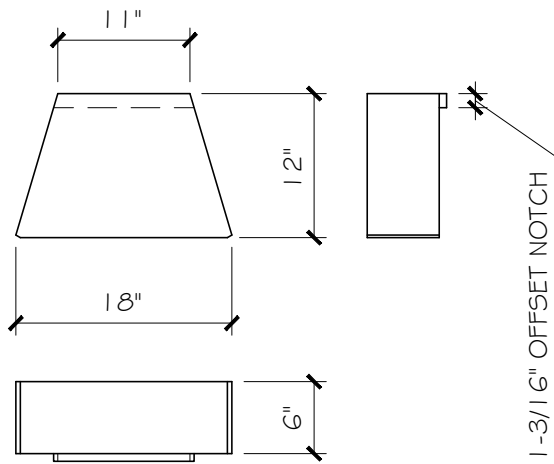

STRAIGHT FACE BLOCK DETAIL

NOT TO SCALE

AT ALTERNATING COURSES
CUT BLOCK FLUSH WITH WALL

FILTER FABRIC
EXTENDING 18" BOTH
SIDES OF WALL

ABUTMENT DETAIL

NOT TO SCALE



MIDCOAST & ASSOCIATES, LLC
636-978-7770
O'FALLON, MO
MO COA #E-2013015539

CAESAR 12 STANDARD
RETAINING WALL SYSTEM

MIDWEST BLOCK & BRICK
12901 ST. CHARLES ROCK RD
BRIDGETON, MO 63044
314-291-3200
314-291-0265 FAX

DETAILS

SHEET 4 OF 10

DATE: APRIL 2014

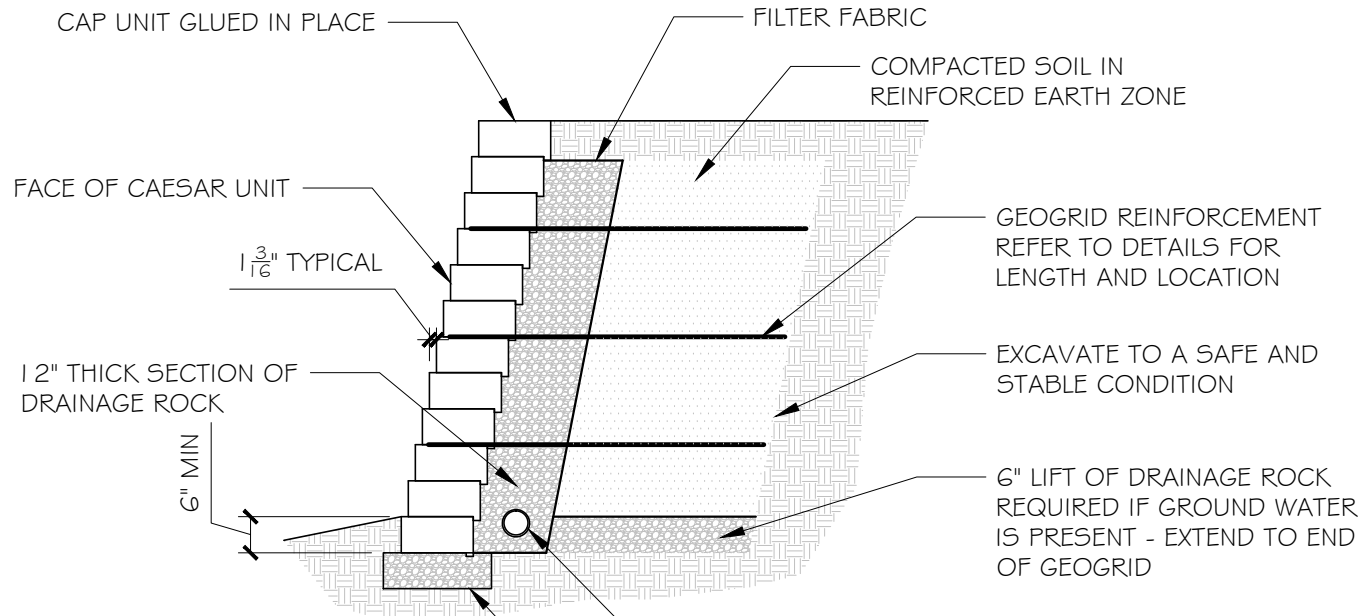

TYPICAL SECTION WITH REINFORCEMENT

NOT TO SCALE

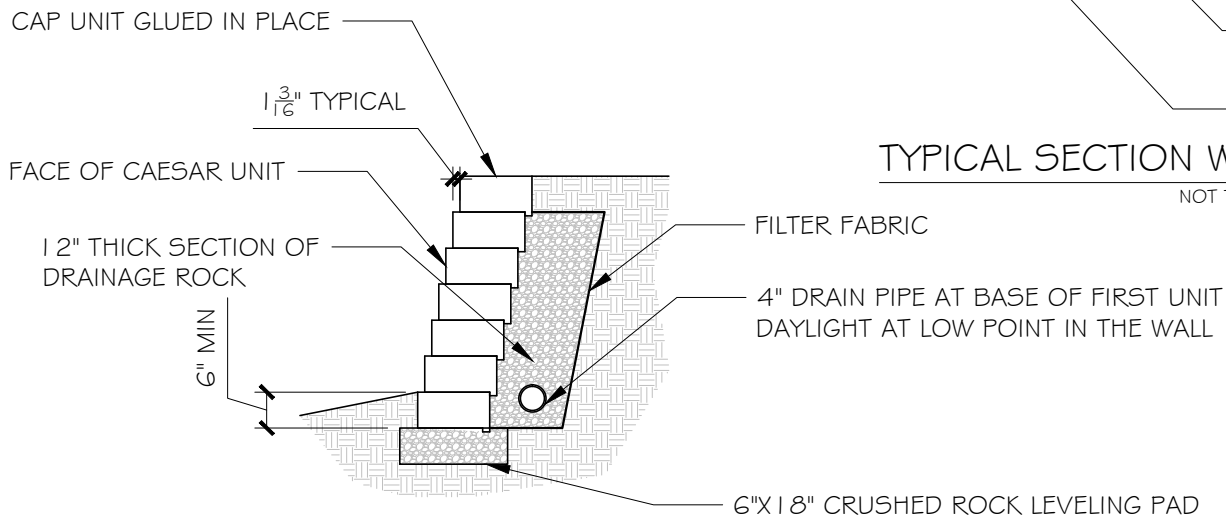

TYPICAL SECTION WITHOUT REINFORCEMENT

NOT TO SCALE



MIDCOAST & ASSOCIATES, LLC
 636-978-7770
 O'FALLON, MO
 MO COA #E-2013015539

CAESAR 12 STANDARD
 RETAINING WALL SYSTEM

MIDWEST BLOCK & BRICK
 12901 ST. CHARLES ROCK RD
 BRIDGETON, MO 63044
 314-291-3200
 314-291-0265 FAX

TYPICAL SECTIONS

SHEET 5 OF 10

DATE: APRIL 2014

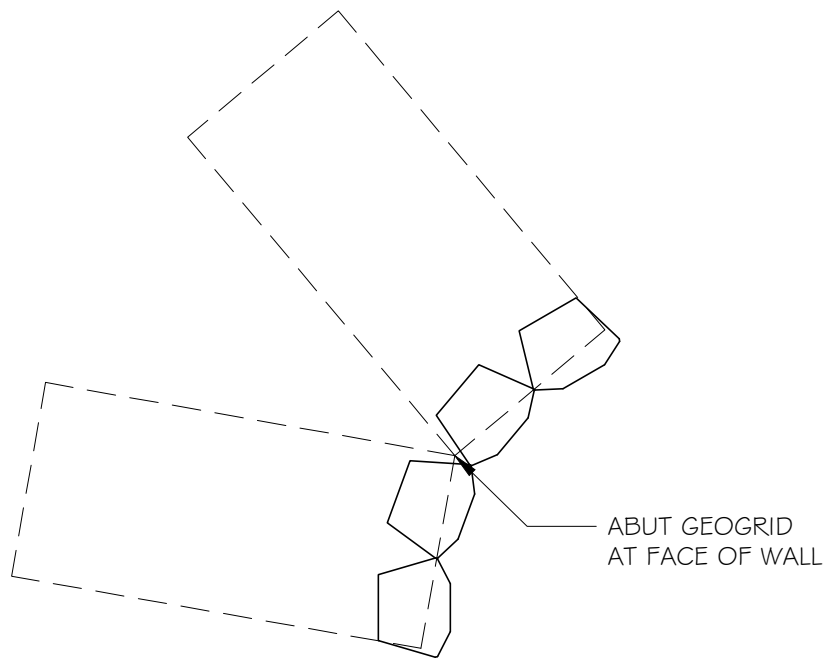

INSIDE RADIUS DETAIL
NOT TO SCALE

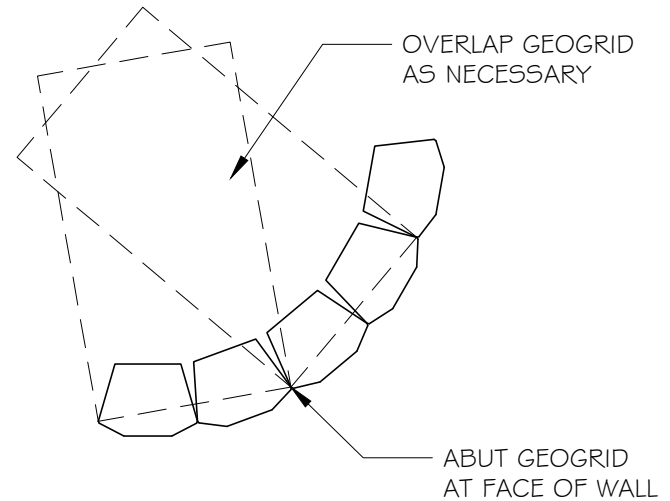

OUTSIDE RADIUS DETAIL
NOT TO SCALE

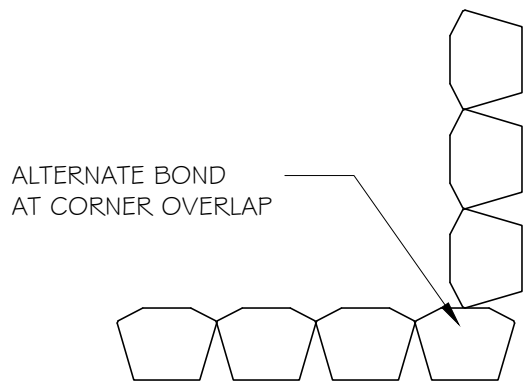

INSIDE CORNER DETAIL
NOT TO SCALE

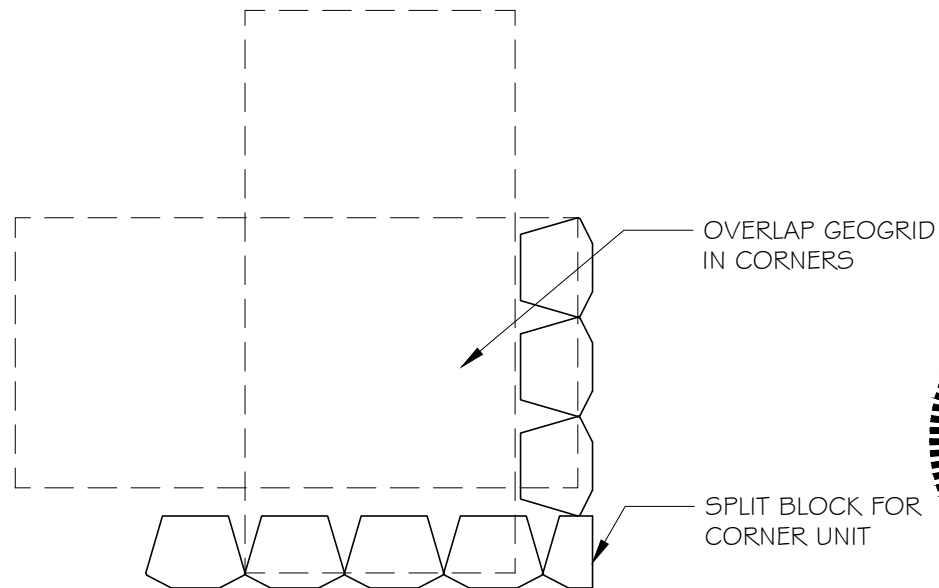

OUTSIDE CORNER DETAIL
NOT TO SCALE



MIDCOAST & ASSOCIATES, LLC
636-978-7770
O'FALLON, MO
MO COA #E-2013015539

CAESAR 12 STANDARD
RETAINING WALL SYSTEM

MIDWEST BLOCK & BRICK
12901 ST. CHARLES ROCK RD
BRIDGETON, MO 63044
314-291-3200
314-291-0265 FAX

DETAILS

SHEET 6 OF 10

DATE: APRIL 2014

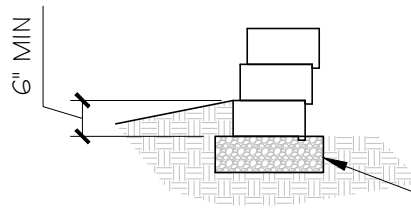
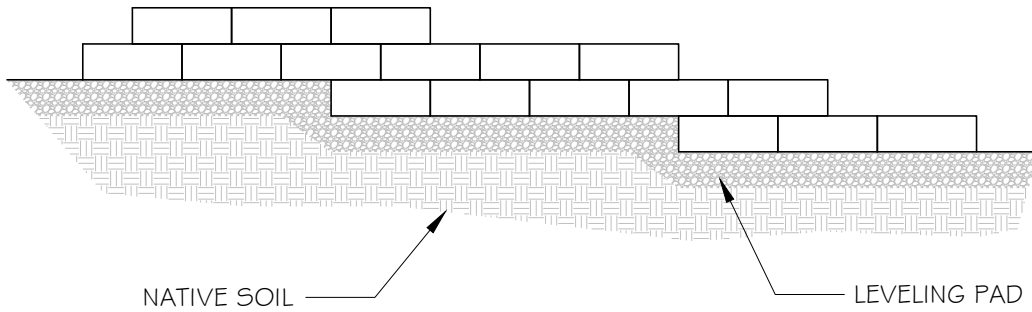

LEVELING PAD MADE FROM CRUSHED ROCK OR UNREINFORCED CONCRETE
MINIMUM SIZE 6" x 18"

LEVELING PAD DETAIL
NOT TO SCALE

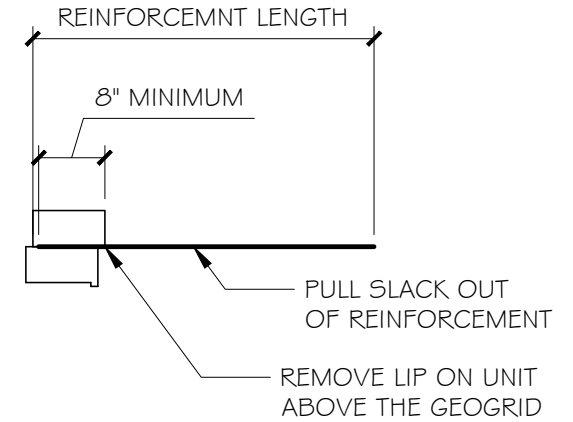

CONNECTION DETAIL
NOT TO SCALE



MIDCOAST & ASSOCIATES, LLC
636-978-7770
O'FALLON, MO
MO COA #E-2013015539

CAESAR 12 STANDARD
RETAINING WALL SYSTEM

MIDWEST BLOCK & BRICK
12901 ST. CHARLES ROCK RD
BRIDGETON, MO 63044
314-291-3200
314-291-0265 FAX

DETAILS

SHEET 7 OF 10

DATE: APRIL 2014

NOTES:

1. GEOGRID LENGTH MEASURED FROM FACE OF WALL.
2. GEOGRID SHALL BE STRATAGRID SG150 OR SG200.
3. BLOCKS DIRECTLY ABOVE GEOGRID SHALL HAVE THE REAR LIPS REMOVED.
4. WALL HEIGHT MEASURED FROM TOP OF LEVELING PAD TO TOP OF WALL.
5. SEE TYPICAL DETAIL FOR BACKFILL REQUIREMENTS AND CONSTRUCTION NOTES.
6. GRADE AT BASE OF WALL IS TO SLOPE AWAY FROM WALL TO PREVENT PONDING.

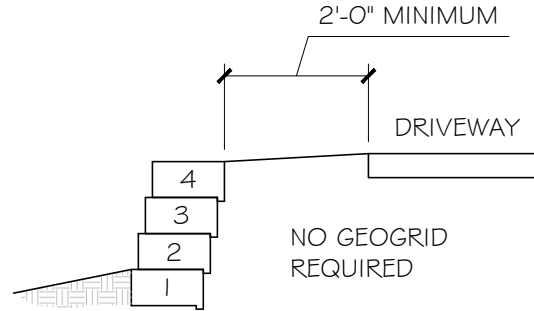

2' TALL WALL

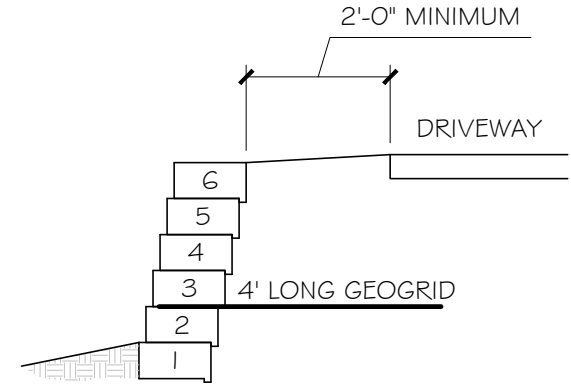

3' TALL WALL

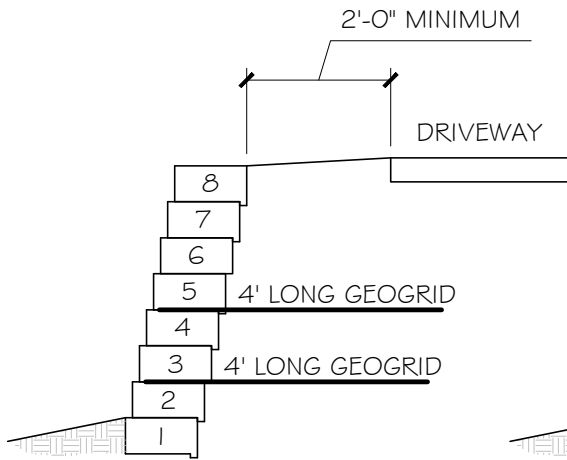

4' TALL WALL

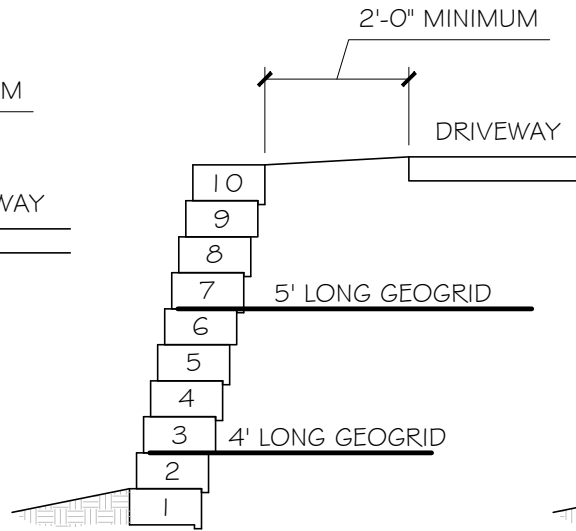

5' TALL WALL

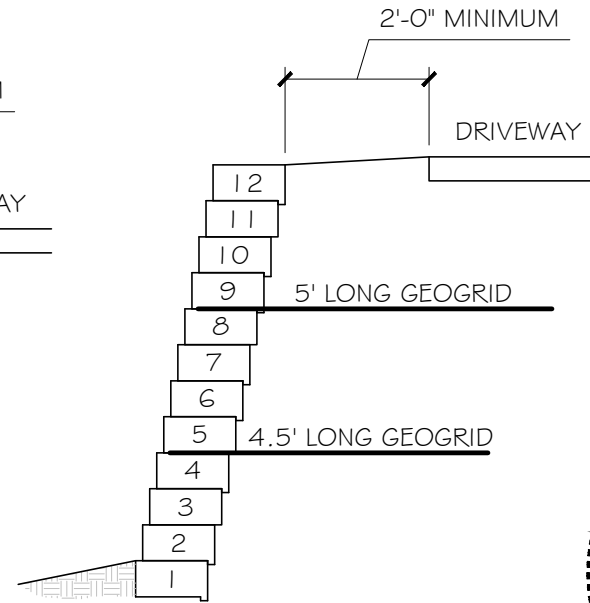

6' TALL WALL

TYPICAL SECTION - 100 PSF SURCHARGE

NOT TO SCALE



MIDCOAST & ASSOCIATES, LLC
636-978-7770
O'FALLON, MO
MO COA #E-2013015539

CAESAR 12 STANDARD
RETAINING WALL SYSTEM

MIDWEST BLOCK & BRICK
12901 ST. CHARLES ROCK RD
BRIDGETON, MO 63044
314-291-3200
314-291-0265 FAX

FLAT BACKFILL

SHEET 8 OF 10

DATE: APRIL 2014

NOTES:

1. GEOGRID LENGTH MEASURED FROM FACE OF WALL.
2. GEOGRID SHALL BE STRATAGRID SG150 OR SG200.
3. BLOCKS DIRECTLY ABOVE GEOGRID SHALL HAVE THE REAR LIPS REMOVED.
4. WALL HEIGHT MEASURED FROM TOP OF LEVELING PAD TO TOP OF WALL.
5. SEE TYPICAL DETAIL FOR BACKFILL REQUIREMENTS AND CONSTRUCTION NOTES.
6. GRADE AT BASE OF WALL IS TO SLOPE AWAY FROM WALL TO PREVENT PONDING.

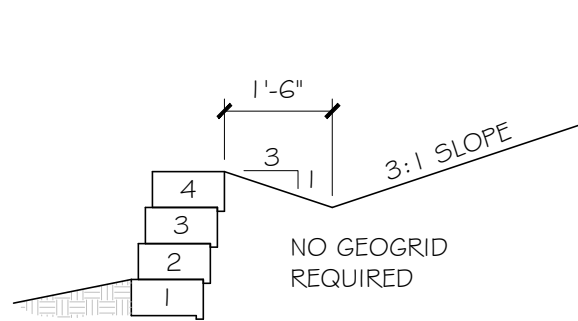

2' TALL WALL

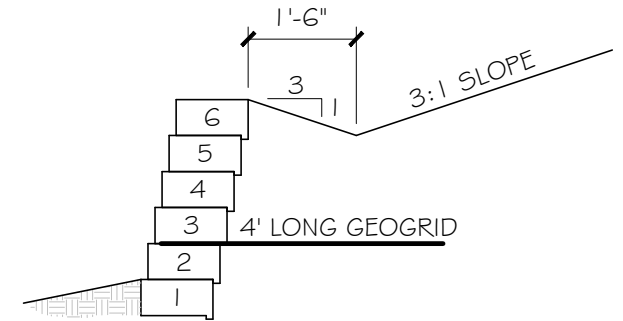

3' TALL WALL

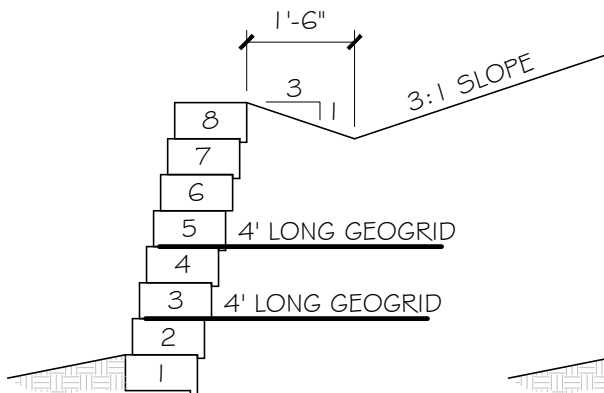

4' TALL WALL

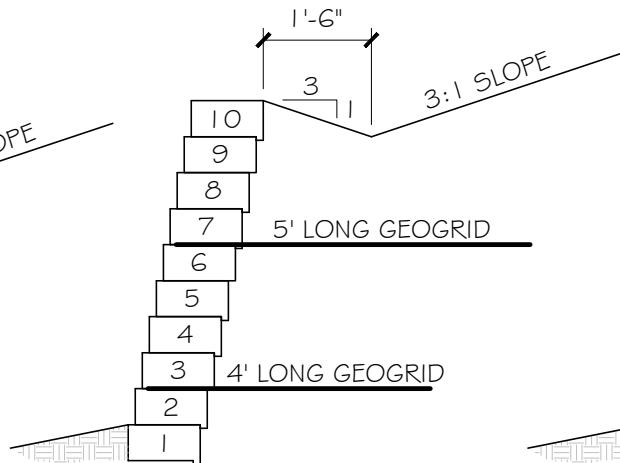

5' TALL WALL

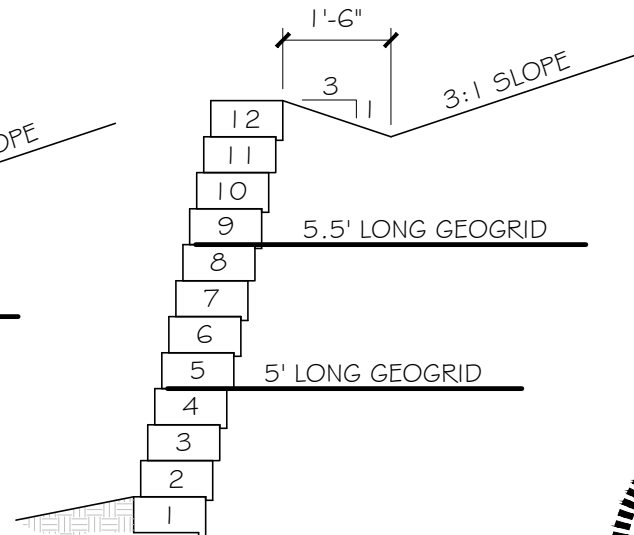

6' TALL WALL

TYPICAL SECTION - SLOPING BACKFILL

NOT TO SCALE



MIDCOAST & ASSOCIATES, LLC
636-978-7770
O'FALLON, MO
MO COA #E-2013015539

CAESAR 12 STANDARD
RETAINING WALL SYSTEM

MIDWEST BLOCK & BRICK
12901 ST. CHARLES ROCK RD
BRIDGETON, MO 63044
314-291-3200
314-291-0265 FAX

SLOPING BACKFILL

SHEET 9 OF 10

DATE: APRIL 2014

NOTES:

1. GEOGRID LENGTH MEASURED FROM FACE OF WALL.
2. GEOGRID SHALL BE STRATAGRID SG150 OR SG200.
3. BLOCKS DIRECTLY ABOVE GEOGRID SHALL HAVE THE REAR LIPS REMOVED.
4. WALL HEIGHT MEASURED FROM TOP OF LEVELING PAD TO TOP OF WALL.
5. SEE TYPICAL DETAIL FOR BACKFILL REQUIREMENTS AND CONSTRUCTION NOTES.
6. GRADE AT BASE OF WALL IS TO SLOPE AWAY FROM WALL TO PREVENT PONDING.

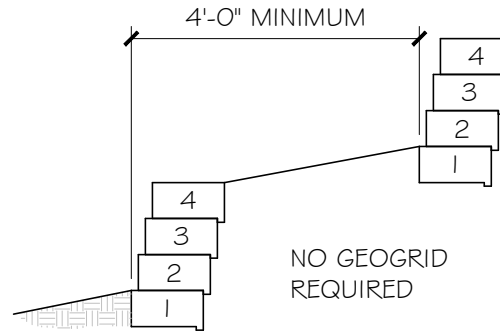
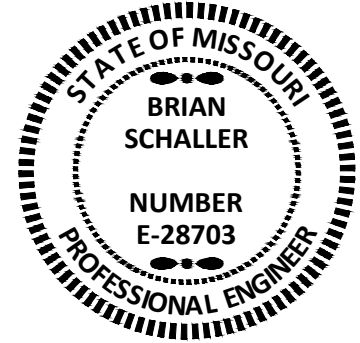

2' TIERED WALLS

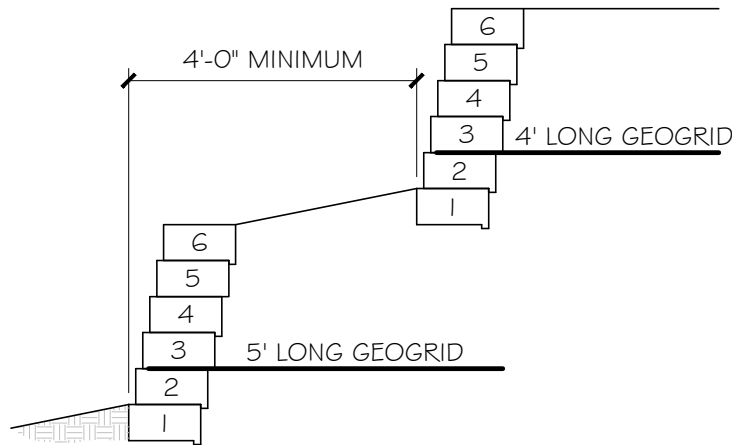

3' TIERED WALLS

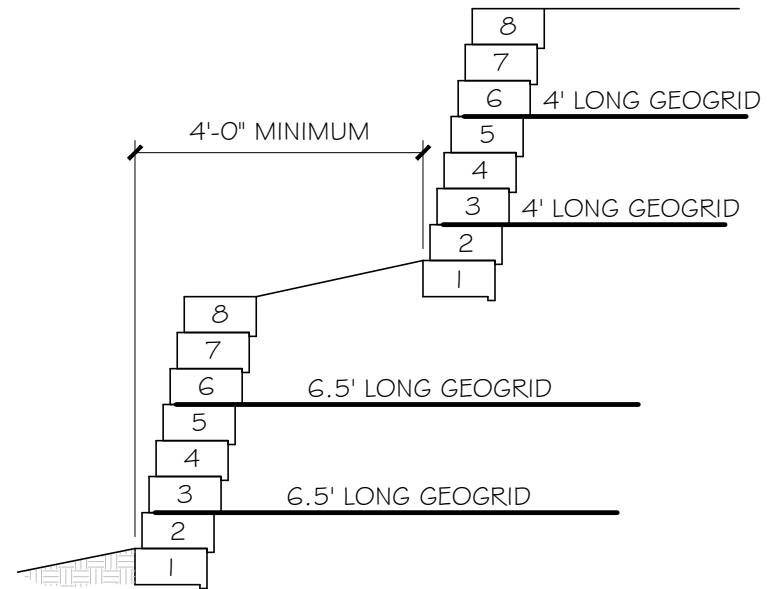

4' TIERED WALLS

TYPICAL SECTION - TIERED WALLS

NOT TO SCALE

MIDCOAST & ASSOCIATES, LLC
 636-978-7770
 O'FALLON, MO
 MO COA #E-2013015539

CAESAR 12 STANDARD
 RETAINING WALL SYSTEM

MIDWEST BLOCK & BRICK
 12901 ST. CHARLES ROCK RD
 BRIDGETON, MO 63044
 314-291-3200
 314-291-0265 FAX

TIERED WALLS

SHEET 10 OF 10

DATE: APRIL 2014